



WATER METER 1"-1.5"

Multi-jet Dry Type Vane Wheel Water Meter With Rotary Register

DN15~DN50

- WM15MC-1.5" (Mechanical)
- WM10MC-1" (Mechanical)
- WM15EC-1.5" (AMI capability)
- WM10EC-1" (AMI capability)

Application

- Measuring the volume of cold potable water passing through the pipeline

Working Conditions

- Water temperature: $\leq 40^{\circ}\text{C}$
- Water pressure: $\leq 1.6\text{ MPa}$

Features

- With external regulating device
- Magnetic drive, lower transmission resistance
- Magnetic shield, for external magnetic field
- Sealed dry dial register ensures clear reading
- Register can rotate more than 360° for easily reading in any position
- Internal strainer
- Inlet strainer

Compliance with Standard

- Technical data conforms to ISO 4064 Class B Standard for horizontal installation

Options

- There are two versions DN50 meter body to choose: with threaded ends and with flanged ends
- Meter for hot water up to 90°C is available
- Can be equipped with reed switch option

Installation Requirements

- The meter should be installed in horizontal position with the register face upwards
- Pipeline must be flushed before installation
- The meter should be constantly full of water during operation

Head Loss Curve

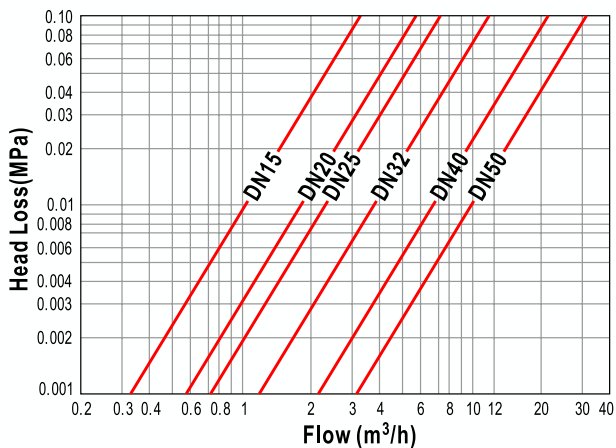

Accuracy Curve

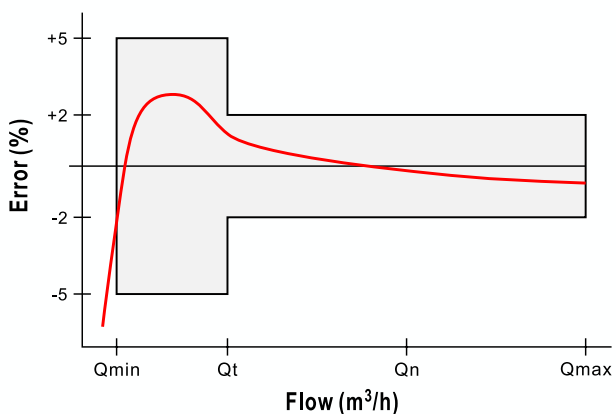

Main Technical Data

Nominal diameter	DN	15	20	25	32	40	50	
Maximum flow rate	m ³ /h	Qmax	3.0	5.0	7.0	12	20.0	30.0
Nominal flow rate	m ³ /h	Qn	1.5	2.5	3.5	6.0	10.0	15.0
Transition flow rate	l/h	Qt	120	200	280	480	800	1200
Minimum flow rate	l/h	Qmin	30	50	70	120	200	300
Maximum reading	m ³		99999.99995				999999.9995	
Minimum reading	m ³		0.00005				0.0005	

- Maximum Permissible Error:
 In the lower zone from Qmin inclusive up to but excluding Qt is $\pm 5\%$
 In the upper zone from Qt inclusive up to and including Qmax is $\pm 2\%$ (cold potable water meter).
 In the upper zone from Qt inclusive up to and including Qmax is $\pm 3\%$ (hot water meter).

Dimension Picture

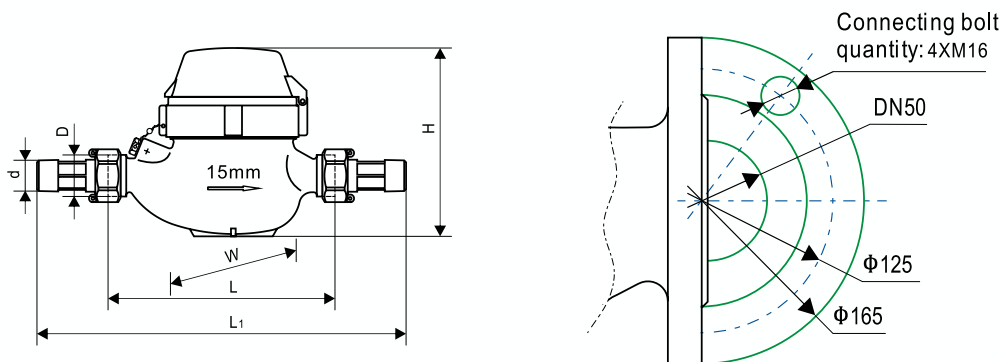

- Nominal diameter and arrow are indicated on the side of the meter body.
- Maximum flow rate and arrow is indicated on the other side.
- The lid can open more than 180°.

Dimensions and Weights

Nominal diameter	DN	15	20	25	32	40	50	
Body thread	D	G3/4B	G1B	G1 $\frac{1}{4}$ B	G1 $\frac{1}{2}$ B	G2B	G2 $\frac{1}{2}$ B	
Connector thread	d	R1/2	R3/4	R1	R1 $\frac{1}{4}$	R1 $\frac{1}{2}$	R2	
Body length	mm	L	145/165	190	225/260	230/260	245/300	300
Overall length	mm	L1	239/259	294	345/380	354/384	376/431	448
Width	mm	W	94	94	99	99	122	145
Meter height	mm	H	117	117	117	117	150	180
Weight without connectors	Kg		1.2/1.3	1.45	3.2/3.5	3.4/3.6	4.8/5.1	8.0
Weight with connectors	Kg		1.38/1.48	1.73	3.72/4.02	4.2/4.4	5.84/6.14	9.72

- DN50(Flanged ends): 11.5 Kg.
- "L1" is the total length when coupling gaskets without compression.